

Limited Warranty

CONSUMER LIMITED WARRANTY: ONE-YEAR WARRANTY

This warranty guarantees that the product purchased is to be free from defects in material and workmanship under normal usage and local voltage for a period of one year.

If you need help regarding product issues, after-sales service, or other relevant problems, please contact us via email or call us.

Email: info@umeworld.net

Cell: (404) 334-3700

Warranty Claim Procedures:

1. Any product the customer believes is defective and seeks for warranty, the customer must provide to Customer Support:

- a) Order numbers
- b) Pictures, video, and/or description are required to claim defective merchandise
- c) Series Number label attached to each product (on the back of remote or electric carbinet)
- e) Any claim for defective merchandise returns must be packed in original packaging.

Warranty Limitations

This warranty only covers failures due to defects in materials and workmanship and does not cover normal wear or cosmetic damages. This warranty does not cover damages that occur in shipment, or failures which result from accident, misuse (including, without limitation, failure to comply with instructions and use restrictions contained in the Operating Instructions), abuse, neglect, mishandling, faulty installation, set-up adjustments, improper operation or maintenance, alteration, modification, power linesurge, lightening, improper line voltage, commercial use such as hotel, office, restaurant, or other business or rental use of the product, service by anyone other than from iBooMas, or damage that is attributable to "acts of God." Continued use of this product after discovering a defect voids this warranty. For product(s) obtained from other Channels, please contact the customer service of the Channel directly for appropriate solution.

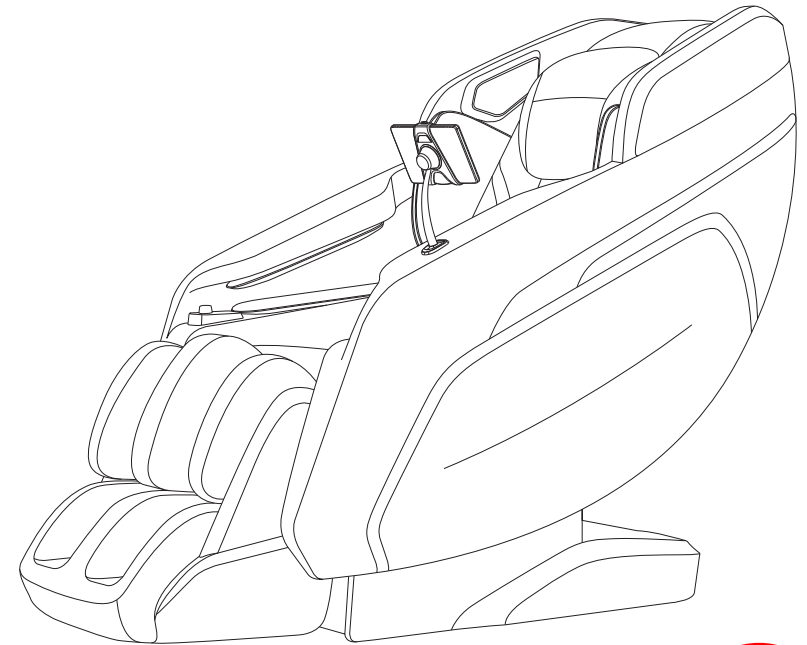

OPERATING INSTRUCTIONS

Tru Iconic (A8)

▶ TRU MASSAGE LOUNGER

Thank you for purchasing the **Tru Massage Lounger**.

Before using this chair for the first time, please read through all sections of this user manual carefully, paying special attention to the Safety Instructions.

PLEASE RETAIN THIS MANUAL FOR FUTURE REFERENCE.

▶ CONTENTS

IMPORTANT SAFETY PRECAUTIONS.....	1
PARTS	3
Exterior Structure	3
Interior Structure	3
MESSAGE CHAIR OPERATION	4
Armrest Controller	4
Armrest Controller Operation	5
Main Controller	6
Main Controller Operation	7
Automatic Programs	8
SETUP	12
Installation	12
Before Using the Chair the First Time.....	15
Massage Chair Placement	15
Move Method	16
Grounding Instruction.....	17
PRODUCT STORAGE AND MAINTENANCE	18
TROUBLESHOOTING.....	19
TECHNICAL SPECIFICATIONS.....	20

▶ IMPORTANT SAFETY PRECAUTIONS

Please pay close attention to the following safety information while using your massage chair. Please carefully read all instructions before using this product.

⚠ WARNING

In order to reduce risk of fire, burns, electric shock or injury to others, please abide by the following instructions:

1. Be sure to unplug the unit when it is unattended. Ensure that it is left unplugged when not in use or before installing or removing any parts.
2. Children and any person requiring special care should use this unit under adult supervision.
3. Be sure to use this unit for the purposes described in this manual. Please do not install parts and accessories not provided by the manufacturer.
4. This unit must not be used under these conditions:
 - a) the power cord or plug is damaged;
 - b) the unit is malfunctioning or operating incorrectly;
 - c) the unit is damaged or exposed to water.Contact our service center for inspection and repair.
5. Do not move this massage chair by pulling the power cord or using the cord as a handle.
6. Be sure to keep the power cord away from any source of heat.
7. Do not use this unit when the air outlet is blocked. Please keep the air outlet unblocked and free from hair and dust.
8. Do not drop or insert any objects into any opening.
9. Do not use this product outdoors.
10. Do not use this product in areas where aerosol products are used or oxygen is being released.
11. To power off, please switch off all controls before unplugging.
12. Please do not stand on or in the unit. It can only be used in a seated position.
13. Be sure to supervise children and ensure that they do not use the unit as a toy or for playing.
14. Connect this unit to a properly grounded outlet only. See Grounding Instructions (Page 17).
15. This unit is not intended for use by persons (including children) with reduced sensory or mental capabilities, or those with a lack of experience or knowledge of its operation, unless they have been given supervision or instruction concerning use of the appliance by a person responsible for their safety. Children should be supervised to ensure that they do not play with the unit.
16. If the covering is torn or worn away, do not use the unit and return to service center for replacement of outer cover.

SAVE THESE INSTRUCTIONS

This massage chair is intended for household use only. Please consult a doctor before using the massage chair if it is to be used by a child or persons with any medical condition.

▶ IMPORTANT SAFETY PRECAUTIONS

⚠ CAUTION

Anyone with the following conditions should consult a medical professional before using this device:

- Persons using embedded medical electronic devices such as a pacemaker.
- Women who are pregnant or who have just given birth.
- Persons with sensory loss or numbness.
- Persons with sensitivity to heat.
- Persons with bodily injuries including open wounds on the skin.
- Persons with bone injuries or with weak bones, loss of bone density, or who are otherwise prone to damaging or bruising bones.
- Persons using blood thinners or who bruise easily.
- Persons with skin disorders or who are prone to allergic reactions of the skin (sensitive skin).
- Any illness or injury that may cause you to be adversely affected by heat or massage pressure.

General Safety Precautions:

- Do not use unit if it shows signs of malfunctioning or damage. Do not use if there are any rips or tears in the fabric that may expose the moving parts underneath, as serious injury can result.
- Setup unit properly by following all instructions in the section "Setup." Failure to follow proper setup and use instructions can cause injury or damage.
- Do not use the unit for longer than 30 minutes at one time. Continual use to one specific part of the body should not exceed five minutes. Excessive massage or heat applied to one area can cause injury or discomfort.
- Do not use the heat function for long periods of time, as low-temperature burns may occur.
- If rashes, skin reddening, itching, or other skin discomfort or skin reactions occur, discontinue use and consult a medical professional.
- Do not leave unit unattended while plugged in. Keep chair powered off and unplugged when not in use or when not supervised.
- Do not sleep in the unit while it is in use.
- For use by only one person at a time.
- Do not use accessories while using the unit, including added heat blankets or pads or other heating units, and including any other massage units or electronic devices.
- Wear loose, comfortable clothing when using the chair.
- Remove items that can cause injury during a massage, including: jewelry, hair accessories and hats, belts, glasses, and any other hard items that could be pressed against your skin. Empty all items from pockets, including wallets.
- Do not unplug or flip the power switch when the unit is in use.
- Do not move the unit while it is in use or while anyone is in it.
- Not intended for use by pets, elderly persons, children, disabled persons, drowsy/inebriated persons, or persons with sensory loss.

▶ PARTS

EXTERIOR STRUCTURE

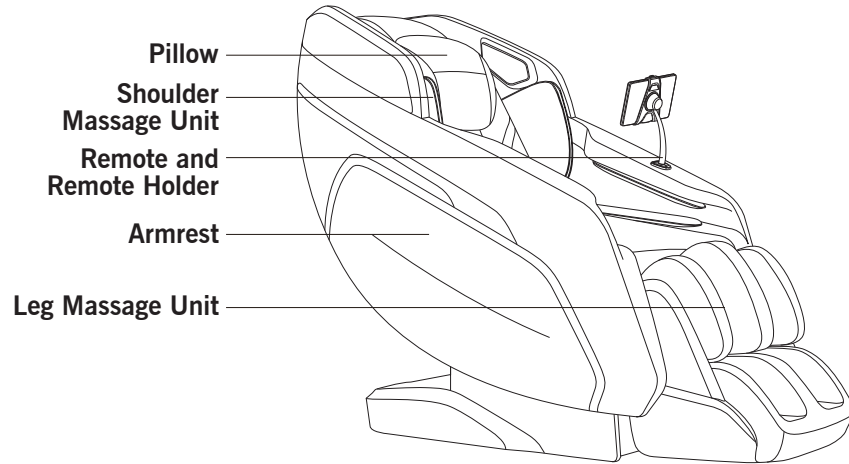
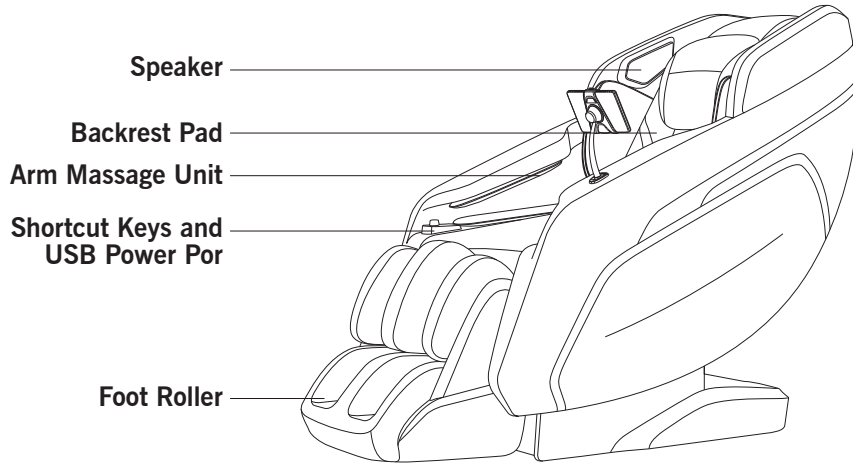

▶ MASSAGE CHAIR OPERATION

ARMREST CONTROLLER

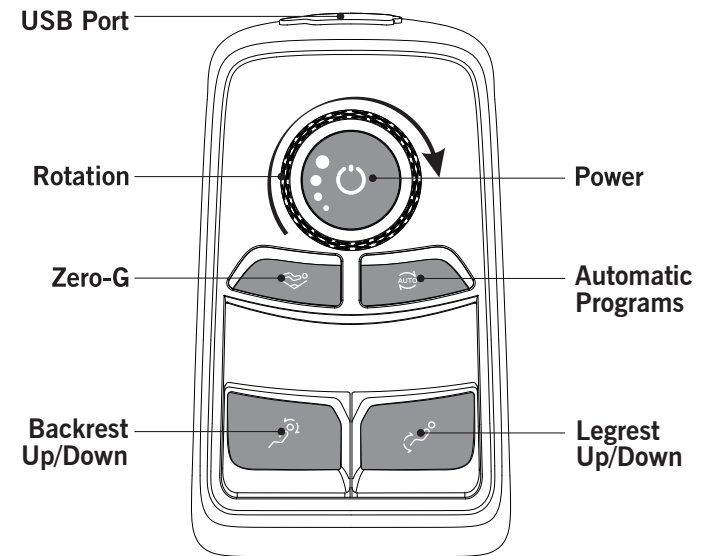

▶ MESSAGE CHAIR OPERATION

ARMREST CONTROLLER OPERATION

The Armrest Controller gives you the convenient access to key functions of your chair. Please use the Main Controller for full access to all of the chair's functions.



Power Button

- ▶ Press to turn ON the massage chair.
- ▶ Press again to turn OFF the chair.



Rotary Switch

- ▶ Rotate clockwise to increase the 3D intensity.
- ▶ Rotate counterclockwise to lower the 3D intensity.
- ▶ There are a total of 5 different 3D intensity options.



Auto Button

- ▶ Press to switch between the automatic programs.



Zero Gravity Button

- ▶ Press to turn ON/OFF Zero Gravity function.



Backrest Up/Down Button

- ▶ Raise or press down to adjust the angle of backrest.
- ▶ Release when it reaches your desired position.



Legrest Up/Down Button

- ▶ Raise or press down to adjust the angle of legrest.
- ▶ Release when it reaches your desired position.

▶ MESSAGE CHAIR OPERATION

MAIN CONTROLLER



- Power Button
- Speaker Voice

CAUTION

- ▶ Do not sit, step or place heavy objects on the controller.
- ▶ Do not drop the controller. It is recommended that the controller be placed in the controller side pocket when not in use.
- ▶ Do not exert excessive force on the controller.
- ▶ Do not handle the controller with wet hands.
- ▶ Do not operate the controller by using sharp-edged or hard objects. It may result in damage.

▶ MESSAGE CHAIR OPERATION

●Auto Interface



Click "Auto mode" to enter the automatic message interface.

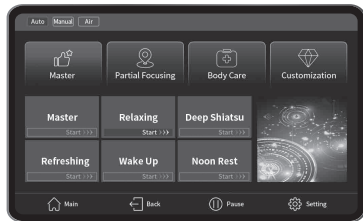

On the Automatic screen, you can select four types, and multiple auto modes for massage.
(Note: When power on and selecting the massage function for the first time, it will enter body scanning automatically and the massage will be run after the scanning is completed)

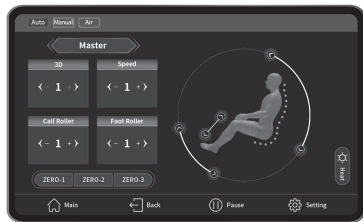

After running the program, it will jump to the adjustment interface, massage strength and other functions can be adjusted. Press "Back" to return to the upper menu.

▶ MESSAGE CHAIR OPERATION

●Body Scanning Interface



When starting the massage chair and selecting the massage function for the first time, it will enter body scanning automatically.

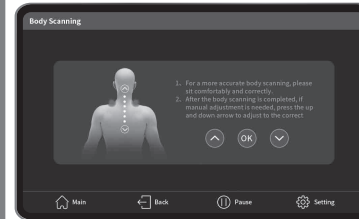

After scanning, you can press "∧" or "∨" to adjust the mechanism positions and then press "OK" to confirm.
(Note: Do not perform the above operation within 8 seconds after the body scanning is completed, shoulder position default current position, run massage function and jump Go back to the screen before detection.)

●Manual Interface



Click "Manual mode" to enter the interface of manual massage.

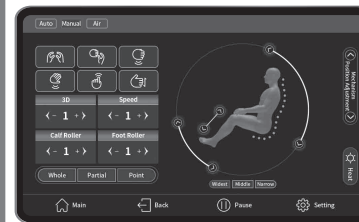

In the "Manual" interface, you can select: 6 massage techniques for massage, and also for adjusting: 3D, massage speed, calf Massage, sole massage, heating and other functions.
Press "Back" to return to the upper menu.

▶ MESSAGE CHAIR OPERATION

● Air Interface



Click "Air Massage" to enter the interface of airbags massage.

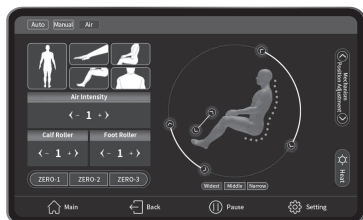

On the Air Pressure interface, you can select body parts: arm, back, Leg, shoulder for pressure massage, at the same time these functions are adjustable: air intensity, calf massage, sole massage, heating and other functions. Press "Back" to return to the upper menu.

● Settings Interface



Click "Setting" to enter the setting interface.



Under the "Settings" interface, select "Message Settings" to adjust 3D, massage speed, air intensity, roller and other functions. Press "Back" to return to the upper menu.

▶ MESSAGE CHAIR OPERATION



On the Settings interface, select Heat to enable the function, Or select 1-3 heating levels. Press "Back" to return to the upper menu.

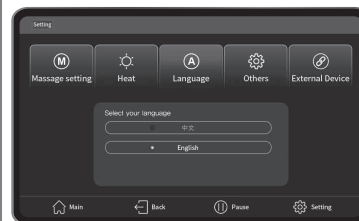

On the Settings interface, select Language to switch to a variety of languages. Press "Back" to return to the upper menu.



On the Settings interface, select Others to adjust the volume, key tone, screen brightness. Press "Back" to return to the upper menu.

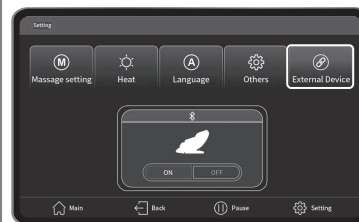

On the Settings interface, click "External Device" for selecting Bluetooth function. Press "Back" to return to the upper menu. On your phone Bluetooth list, choose the model "Tru Iconic" to do the pairing.

▶ MASSAGE CHAIR OPERATION

Auto Mode

01	Master	13	Slim
02	Relaxing	14	Gentle Care
03	Refreshing	15	Yoga
04	Deep Strech	16	Spa
05	Noon Rest	17	Space
06	Sport Care	18	Wake Up
07	Neck & Shoulder	19	Soft
08	Waist & Back	20	Gentleman Care
09	Spine Care	21	Golf
10	Lumbar Care	22	Deep Sleep
11	Calf Care	23	Deep Shiatsu
12	Sole Relieving	24	TCM Recuperaing

▶ SETUP

INSTALLATION METHOD

STEP 1: Unpack All Parts

- ▶ Carefully lift the chair and all of its parts from packaging.
- ▶ Remove any protective wrapping and check to make sure that all parts are present.
- ▶ Before beginning installation, please verify all components are included.

Step 2: Install the controller

- ▶ Connect the cable of the remote with the cable under the seat.

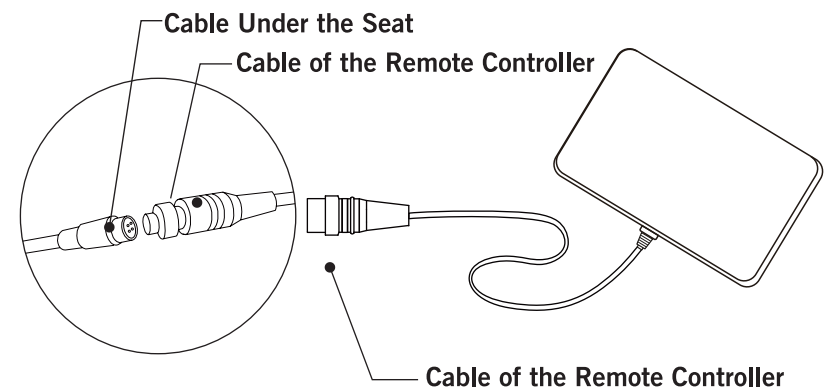

Step 3: Install the remote holder

- ▶ Aligned holes, lock screw.
- ▶ Press down to align the snap.

Note: The arrow direction is towards the front of the handrail.

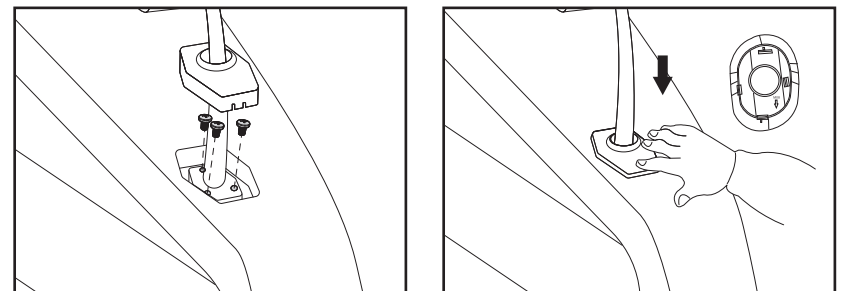

▶ SETUP

Step 4: Install the Backrest Pad and Pillow

- ▶ Attach the upper backrest pad to the backrest with the zipper.
- ▶ Attach the pillow pad to the backrest by connecting the velcro.



- ▶ Attach each side of the backrest pad with the zipper closer.

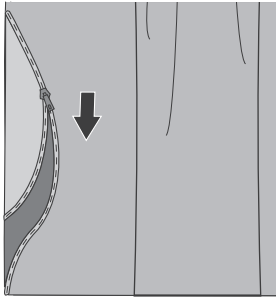

▶ SETUP

Step 5: Install Legrest

- ▶ As shown in the figure, insert the air tube **1** and DC cable **2** into the slots.

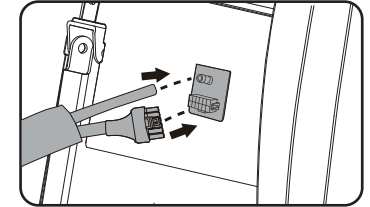
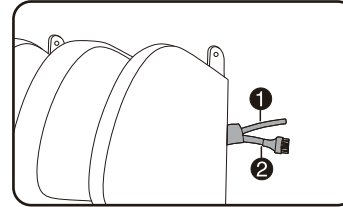

- ▶ As shown in the figure, install the slots **3** of legrest into fixed part **4**.

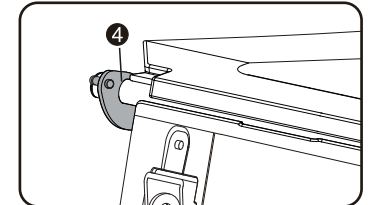
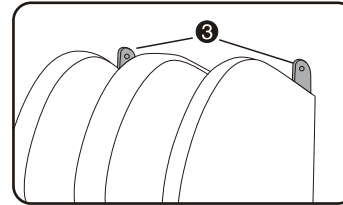

- ▶ As shown in the figure, insert the lock buckle **5** into each side, installation finished.

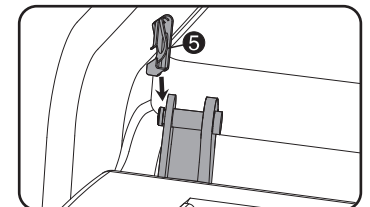
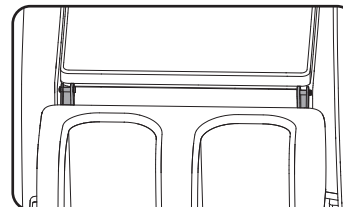

▶ SETUP

BEFORE USING THE MASSAGE CHAIR FOR THE FIRST TIME

- ▶ Make sure there are no objects, people, or pets in the vicinity of the unit.
- ▶ Check that the chair has room to recline. Allow at least 14 in. of open space in front of the legrest and 5 in. behind the backrest.
- ▶ Use the controller to lower the backrest to its furthest outstretched position.
- ▶ Raise the legrest to its highest position. Make sure that the legrest is properly connected to the chair.
- ▶ Press the power button to return the chair to its original, upright position.

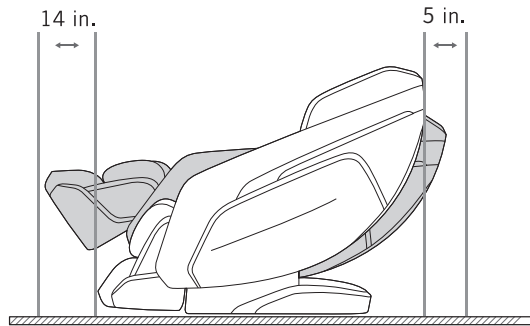

MASSAGE CHAIR PLACEMENT

- ▶ Ensure adequate space to recline.
- ▶ Do not expose the massage lounger to direct sunlight or high temperatures, such as in front of heating sources because this can cause discoloration or hardening of the synthetic leather.
- ▶ Place the unit on a mat to prevent floor damage.
- ▶ Install the unit near a power socket.
- ▶ Be sure to place the chair within 4ft of a power plug.

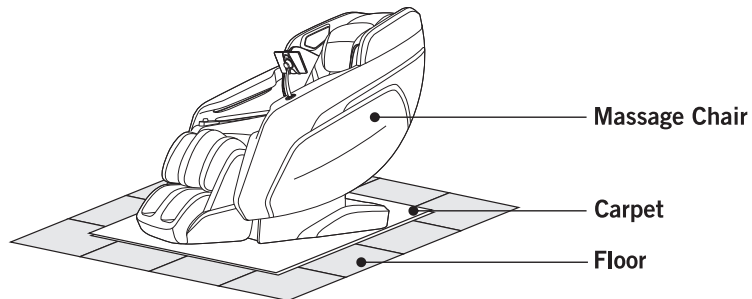

▶ SETUP

MOVE METHOD 1

- ▶ Turn off the main power and unplug the power from the electrical outlet.
- ▶ Tilt the chair backwards as shown below and wheel to desired location. Be sure to cover the floor with a mat when moving the massage chair to not damage the floor.

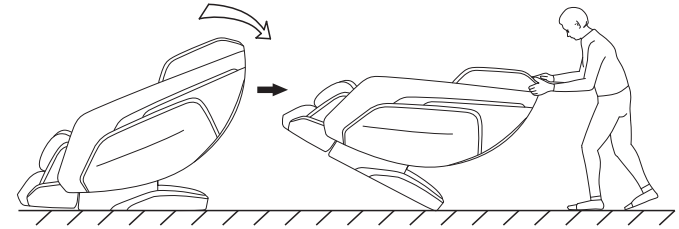

MOVE METHOD 2

- ▶ Two people reach under the chair on each side of the arms and hold the steel frame to avoid damage to the rest of the chair.
- ▶ Move to desired location and carefully place the chair on the ground.

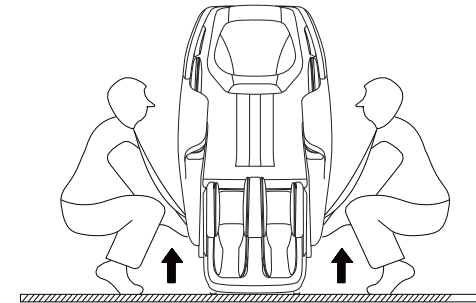

⚠ CAUTION

- ▶ Do not attempt to move the chair while someone is still sitting on it.
- ▶ Do not move the chair by pulling its armrests, as the armrests can dislodge.
- ▶ Before plugging it in, inspect the entire power cord and plug for any possible damage. Make sure that no electrical wires are exposed.
- ▶ Make sure that the power supply switch is turned OFF before inserting the power plug into a wall outlet.

▶ SETUP

GROUNDING INSTRUCTIONS

This unit must be grounded. If it should malfunction or breakdown, grounding provides a path of least resistance for electric current to reduce the risk of electric shock. This product is equipped with a cord having an equipment-grounding conductor and a grounding plug. The plug must be plugged into an appropriate outlet that is properly installed and grounded in accordance with all local codes and ordinances.

TURNING ON THE POWER

- ▶ Plug the power cord into the port at the base of the chair.
- ▶ Plug the three-pronged power plug into a properly grounded three-pronged power outlet.
- ▶ Flip on the power supply switch, located on the back of the massage chair at the base of the backrest.

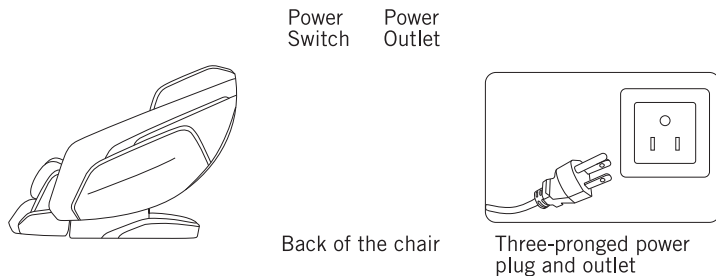

⚠ DANGER

- ▶ This product is for use on a nominal 100-240V circuit and has a grounding plug that looks like the plug illustrated. Make sure that the product is connected to an outlet having the same configuration as the plug. No adapter should be used with this product.
- ▶ Improper connection of the equipment-grounding conductor can result in a risk of electric shock. Check with a qualified electrician or serviceman if you are in doubt as to whether the product is properly grounded. Do not modify the plug provided with the product – if it will not fit the outlet, have a proper outlet installed by a qualified electrician.

▶ PRODUCT STORAGE AND MAINTENANCE

CLEANING

- ▶ Before cleaning, switch OFF power and remove the power plug from the wall outlet.
- ▶ Dip a soft, cotton cloth in neutral detergent and wring dry. Use it to wipe the pillow cushion, back cushion, armrests, legrests, and any plastic parts of the chair.
- ▶ Use a piece of wet cloth (without detergent) to re-wipe the pillow cushion and back cushion.
- ▶ Use a soft, dry cloth to re-wipe the armrests, legrests, and any plastic parts of the chair.
- ▶ Use a soft, dry cloth to wipe the controller, and the power supply box.
- ▶ To clean the foot/calf unit covers, remove them from the chair, hand wash with mild detergent and hang dry.

⚠ CAUTION

- ▶ Before any maintenance, always disconnect the power plug from the wall outlet.
- ▶ To avoid electric shock, never touch the power plug with wet hands.
- ▶ When cleaning the back cover of the massage chair, do not allow any detergent to seep into the power supply box.
- ▶ Do not use abrasive chemicals, such as benzene or alcohol, to clean this chair. Damage to the chair may result.
- ▶ Do not apply an iron or any other heated device to the chair.

STORAGE

When not in use, be sure to switch off power and detach the power plug from the wall outlet. Before putting into storage, wipe off all accumulated dirt and dust from the surface of the chair. Cover the entire surface of the chair with a dust cover (not included).

⚠ CAUTION

- ▶ Do not store the product under direct sunlight, nor in a location with high temperatures. Doing so may cause the upholstery to fade.
- ▶ Do not allow massage chair to remain in contact with vinyl or wallpaper for extended periods of time as this could lead to discoloration.

MAINTENANCE

Upon detecting any of the following conditions during daily use, immediately turn off power, disconnect the power plug from the wall outlet, and contact an authorized repairman:

- ▶ A burning smell
- ▶ The power cord feels hot
- ▶ Any other abnormal functioning
- ▶ The cord is plugged in and the power switch flipped on, but no functions operate

▶ TROUBLESHOOTING

No.	Problem	Check the Following:	Explanations / Remedies
1	Noise is heard during operation.	N/A	These noises are normal and arise from slight friction between the massage rollers and the leather cover.
2	Operation fails to start.	The power cord is not secured to the socket.	Insert the power plug properly into the power socket.
		Power Switch is off.	Turn on the switch.
		The fuse is blown.	Replace with a fuse of the same type.
3	Airbags within the seat and the Legrest fail to work properly.	Are the air tubes blocked?	Straighten the air tube and clear it of any blockages.
4	No music comes from the speakers.	The volume is turned to the lowest setting.	Adjust the speaker volume from the mobile device
		Bluetooth didn't connect with the music device.	Reconnect to the Bluetooth.
5	Backrest or footrest cannot ride or recline.	Excessive load has been pressed on the backrest or legrest.	Reduce the load and try again later.
6	Massag rollers stop working.	Too much stress on the massage rollers.	Reduce the load and try again later.

If problems persist after applying the suggestions above, turn off power and remove the power plug from the wall outlet. Then contact the manufacturer for maintenance and repair.

⚠ IMPORTANT

Do not attempt to dismantle or repair the chair by yourself. Doing so will void the warranty and U.S. Jaclean, Inc. will not bear any responsibility for any subsequent consequences.

▶ PRODUCT SPECIFICATIONS

Product Name: Tru Iconic

Product Model: A8

Rated Voltage: 120V~

Rated Frequency: 60Hz

Rated Power: 200W

Safety Design: Class I

